

Model	Product name	Product picture	Size	Sensor data
UER	PIR Motion Sensor			Sensitive field: $\leq 3m$ Sensitivity angle: 120
UEW	Wood Touch Sensor			Dimming range: 0-100% PWM Frequency: 2KHz Detective distance: $\leq 5cm$
UEC	Touch Sensor			Dimming range: 0-100% PWM Frequency: 128Hz
UED	Door Sensor			Detective distance: $\leq 10cm$ Detective angle: 15-30
UEB	Hand Sweep Sensor			Detective distance: $\leq 8cm$ Detective angle: 15-30

Features

- Powered by low voltage 5VDC, output 5V level or PWM signal.
- PIR motion sensor: when people enter the sensitive field, the light turn on; when people exit the sensitive field, the light turn off after 30 seconds.
- Wood touch Sensor: the medium can be wood, glass or plastic.
Short touch the sensing area to turn on or turn off light; long touch the sensing area to dimming up or down.
- Touch sensor: short touch the LED to turn on or turn off light; long touch the LED to dimming up or down.
- Door sensor: when the door open, or no obstacle ahead, the light turn on gradually; when the door close, or obstacle ahead, the light turn off gradually.
- Hand sweep sensor: when hand sweep, the light turn on gradually; when hand sweep again, the light turn off gradually.

Sensor wire define

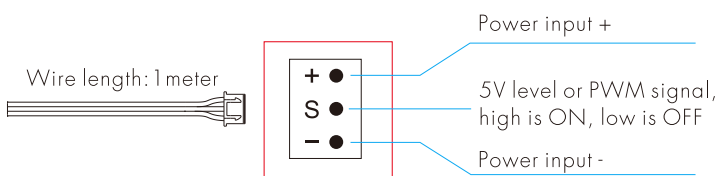

UER PIR Motion Sensor

Ceiling mounting pattern

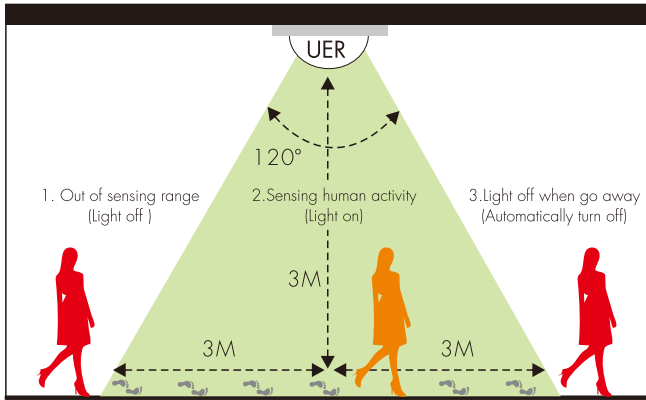

Wall mounting pattern

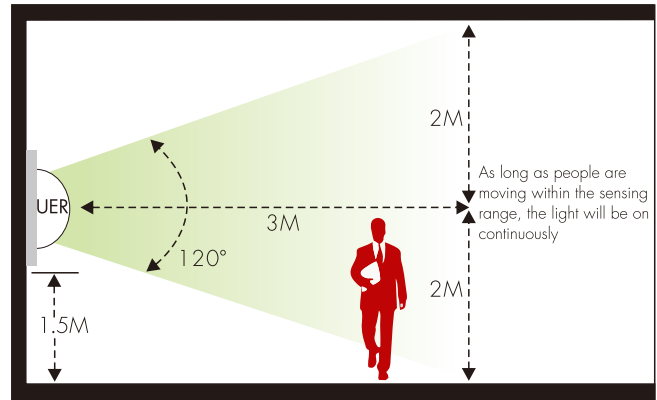

When installing, please pay attention to choosing a proper position and angle, otherwise the sensing distance will be very close or the sensing will be insensitive

UEW Wood Touch Sensor

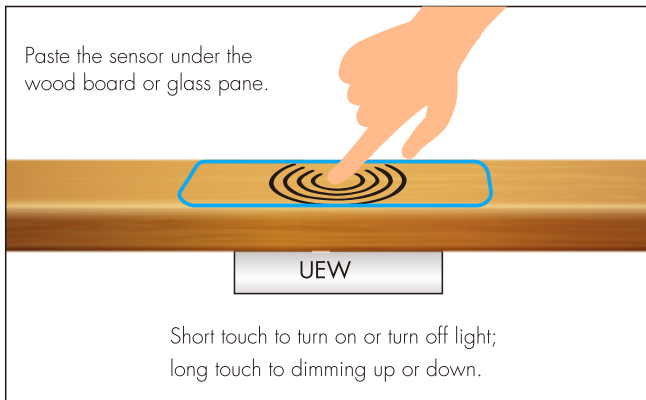

UEC Touch Sensor

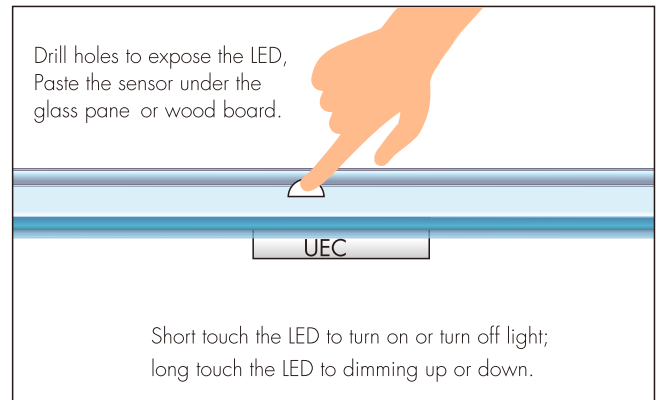

UED Door Sensor

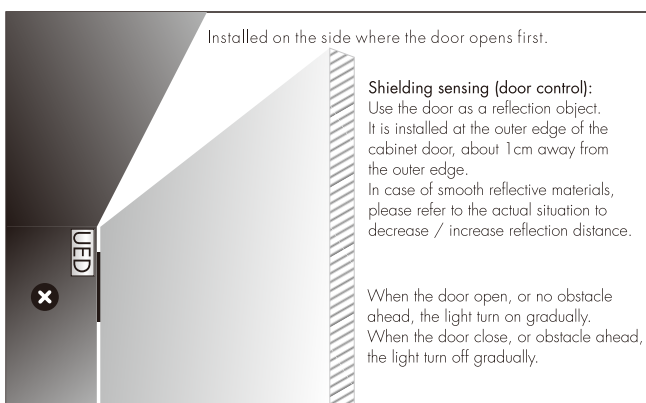

UEB Hand Sweep Sensor

