



LED STRIP SPECIFICATION

30mm,24v,1600chips/m,COB strip.



Part Number: LED1600-COB-W30-24V-40W-30mm
 W27/W30/W40/W65

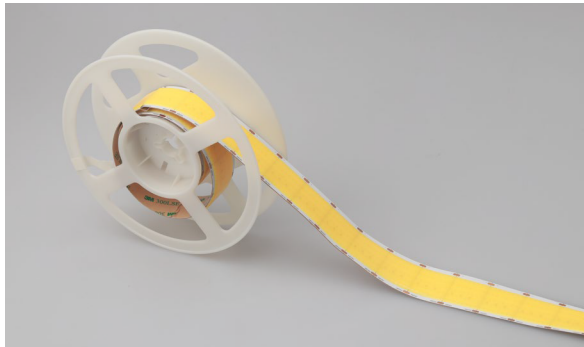

Description

Wide cob led strip, dotless, no hot spot.
 24V, Step length: 25mm
 with 3M adhesive tape on the back for easy installed.
 180° beam angle. Very good color reproduction with CRI>90.



Dimensions & Waterproof

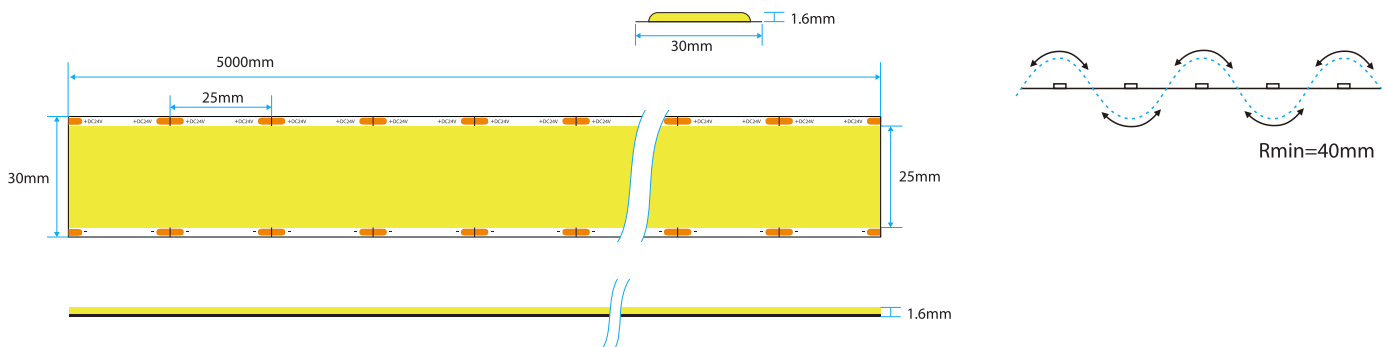

Product Specification

Dimension	5000x30x1.6mm
Chip Type	COB
Chips/m	1600pcs
Step LEDs	40pcs
Step Length	25 mm

Voltage(V)	DC24V
Current(A/m)	1.67A
Power(W/m)	40W/m
Beam Angle	180°
Operation Temperature	-20°C - 45°C

Product Photometrics

CCT(K)	Lumen(lm/m)	Efficacy(lm/w)	CRI	Power
2700K	4200	105	80+	40W/m
3000K	4600	115	80+	40W/m
4000K	4800	120	80+	40W/m
6500K	5000	125	80+	40W/m
2700K	3800	95	90+	40W/m
3000K	4200	105	90+	40W/m
4000K	4400	110	90+	40W/m
6500K	4600	115	90+	40W/m

* the given electrical data reflect typical values, each can vary up to 10%.

Temperature Curve

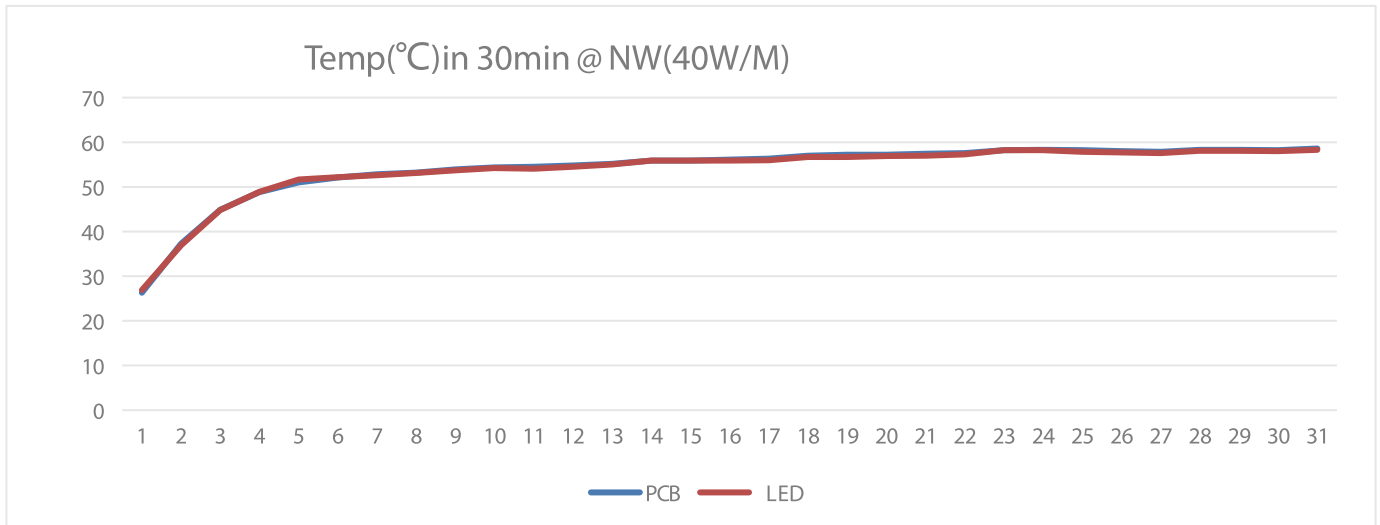

The above curves indicate the temp. changing in LED & PCB within 30 minutes after powering on, under the ambient temperature of 25 °C.

Brightness Consistency

The following charts shows the parameters on each meter based on 5M length.

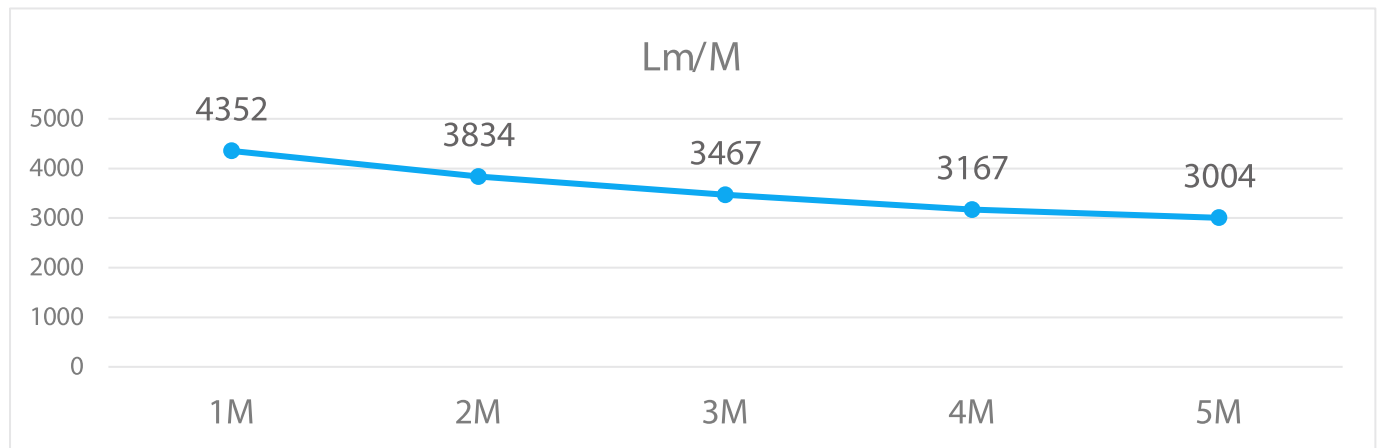

From above chart, please connect 5M at most by one-end power to keep brightness consistency.

Applications

* Residential lighting, decorative lighting.

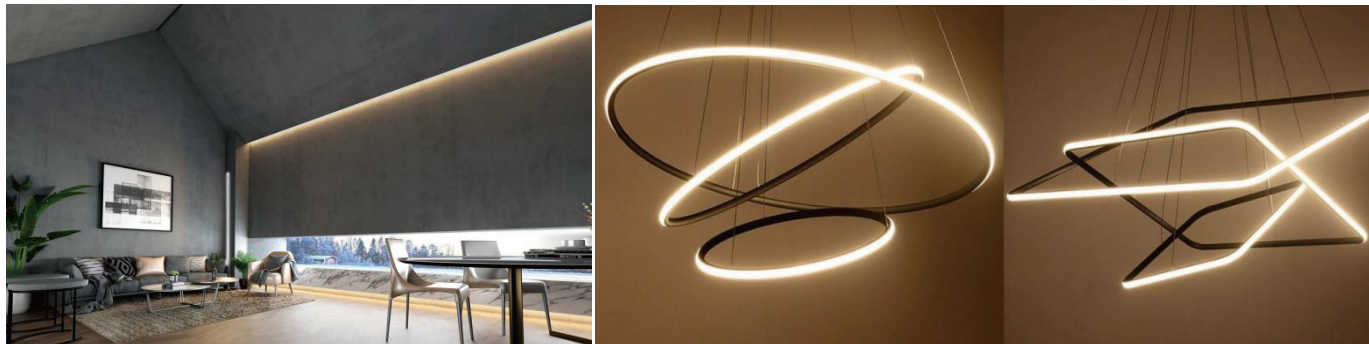

Packing Information (Data base on IP20)

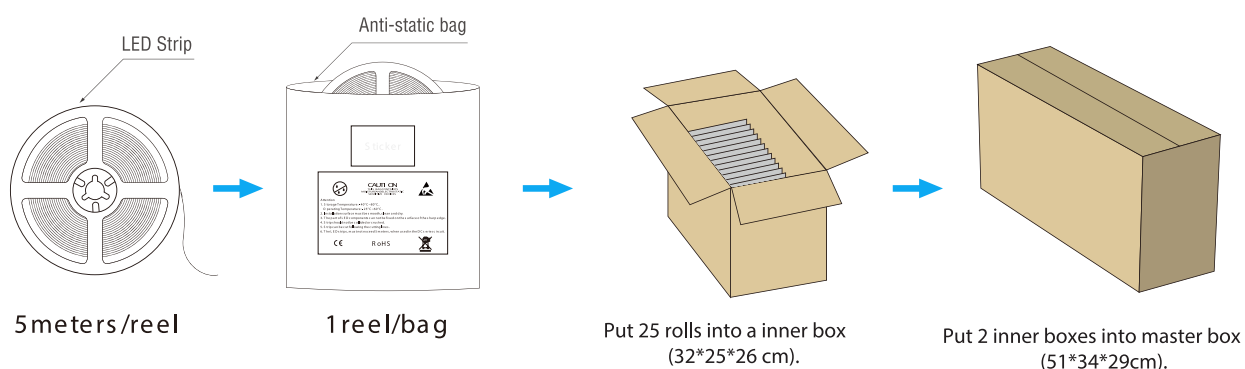

Precautions for use

1. To protect the LED light strip, do not hit the light-emitting area with hard things.
2. After unpacking, please use in 24H to avoid the oxidation effect of solder joints.
3. Avoid direct contact with high temperature objects in the light-emitting area of the lamp, and the instantaneous contact temperature of the surface of the light-emitting area should be less than 210 °C.
4. The soldering iron temperature should be less than 300° during soldering, and the soldering time of single solder should be controlled within 3s.
5. It is strictly forbidden to twist the lamp with short distance. The single lamp strip (0.5 m) has a maximum twist angle of 7 20°.



6. The bend diameter at any position needs to be greater than 1cm.

